

Digital IR Color CCD Camera

● ITEM No: DVCCMD608NIR

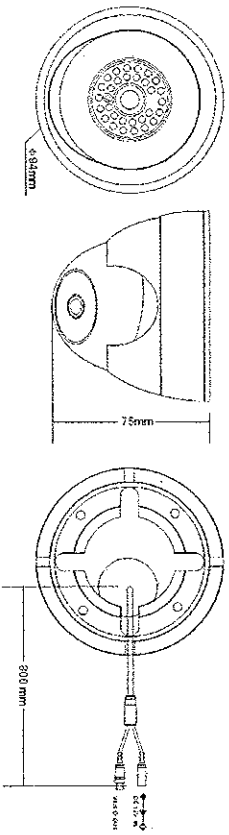

- **Caution for Installation**
 1. In order to prevent electronic shock, don't loosen any screws or covers.
 2. Do not directly touch the front glass. If necessary, use a soft cloth moistened with alcohol to wipe off the dust.
 3. Avoid places where there are frequent vibrations or shocks.
 4. Don't operate the camera beyond its temperature, power source ratings.
 5. When any abnormalities happen, make sure to unplug the camera and contact your local dealer.

- **Packing**
 1. Camera X1
 2. User Manual X1
 3. Screw X4
 4. Plastic-Conical-Anchor X4
 5. Hexagonal Wrench X1

● Specification

ITEM	DVCCMD608NIR
Type	Color/Monochrome
Signal System	NTSC/PAL
Pick Up Device	1/3" Sony Color CCD
Picture Elements	NTSC:537H*505V PAL:537H*597V
Resolution	420 TV Line
Min Illumination	0Lux (24 Pieces IR LED ON)
Vertical Frequency	NTSC:60Hz PAL:50Hz
Horizontal Frequency	NTSC:15.734KHz PAL:15.625KHz
Clock Frequency	NTSC:28.636MHz PAL:28.375MHz
Scanning System	2:1 Interface
S/N Ratio	≥46dB
Electronic Shutter	NTSC:1/60-1/100,000S PAL:1/50-1/100,000S
Lens	3.6mm Board Lens
White Balance	AUTO Tracking
Gain Control	AUTO
GAMMA	0.45
Video Out-put	1V p-p,75Ω
Power Supply	DC12V ±5%
Current Consumption	280mA(MAX)
IR Effect Distance	15M (Outdoor)
Dimension	Φ94×80mm
Weight	350g
Storage Temperature	-30~+60℃
Operating Temperature	-10~+40℃

Remark: Non-regulative adaptor may cause camera damaged.